

GREEN OAK TWP, LIVINGSTON COUNTY

DIXBORO RD.

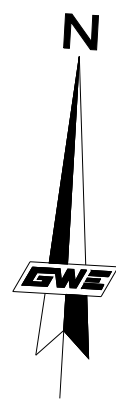

SCALE: 1"=1000'

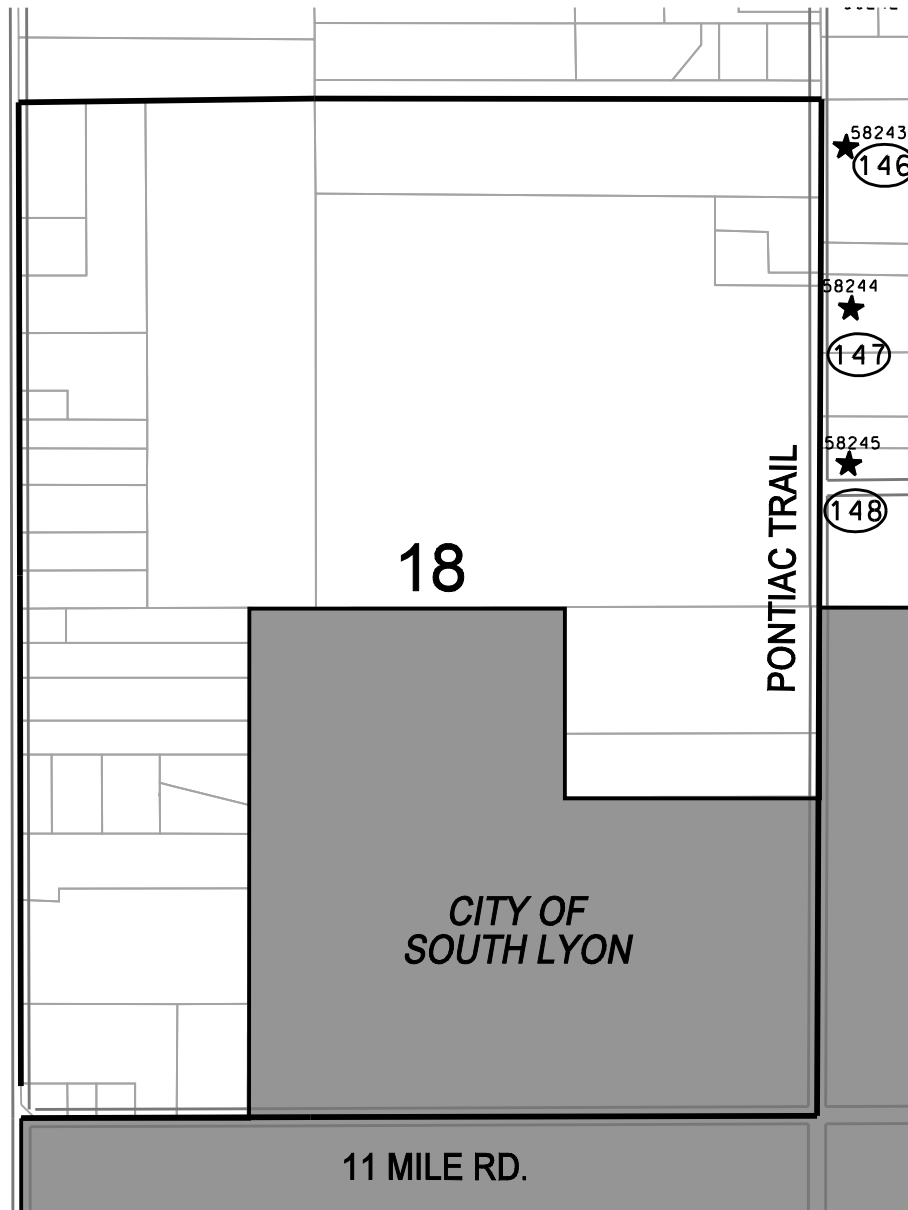
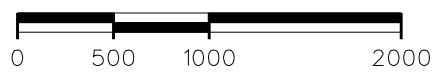

# LYON TOWNSHIP BENCHMARKS

## SECTION 18, T-1-N, R-7-E

Copyright © 2006 Giffels-Webster Engineers, Inc. No reproduction shall be made without the prior written consent of Giffels-Webster Engineers, Inc.



**Giffels-Webster Engineers, Inc.**  
 ENGINEERS LAND SURVEYORS PLANNERS LANDSCAPE ARCHITECTS  
 2871 BOND STREET, ROCHESTER HILLS, MI. 48309  
 (248) 852-3100

|                |              |      |                 |
|----------------|--------------|------|-----------------|
| DATE: 03/31/06 | CHECKED BY   | DATE | SCALE: 1"=1000' |
| DRAWN: JJK/RAS | JWB/KS/MD    | 3/06 | SHEET: 1 OF 2   |
| DESIGN:        |              |      | JOB No:         |
| SECTION: 18    | T-1-N, R-7-E |      |                 |

# LYON TOWNSHIP BENCHMARKS

## SECTION 18, T-1-N, R-7-E

VERTICAL DATUM ESTABLISHED BY NGVD 29 STANDARD

Copyright © 2006 Giffels-Webster Engineers, Inc. No reproduction shall be made without the prior written consent of Giffels-Webster Engineers, Inc.



**Giffels-Webster Engineers, Inc.**  
ENGINEERS LAND SURVEYORS PLANNERS LANDSCAPE ARCHITECTS  
2871 BOND STREET, ROCHESTER HILLS, MI. 48309  
(248) 852-3100

|                |              |      |               |
|----------------|--------------|------|---------------|
| DATE: 03/31/06 | CHECKED BY   | DATE | SCALE: N/A    |
| DRAWN: JJK/RAS | JWB/KS/MD    | 3/06 | SHEET: 2 OF 2 |
| DESIGN:        |              |      | JOB No:       |
| SECTION: 18    | T-1-N, R-7-E |      |               |